

Platform scale for measurement and control in hazardous areas.

Technical Specification

DESCRIPTION

The FL-AWB scales are robust electronic scales for use in hazardous areas. The scales are approved for use in Zone 1 or Zone 2 for potentially explosive atmospheres created by gas groups IIA, IIB or IIC. The easy to read digital display can be stand or wall mounted to suit your application.

FEATURES AND BENEFITS

Backlit Display – Supplied with a large, six-digit, 52 mm high, seven segment display with configurable backlight (on, off or on only when weighing).

Dual Power – Powered by either the internal rechargeable battery or via the mains. The scale is equipped with power saving options such as auto power-off and switching backlight off at zero.

Keyboard – Seven simple to use, large push buttons with multifunctional use.

Low Battery Warning – LED annunciator next to display warns of low battery condition.

Checkweighing Mode – Allows a low and high limit to be set. Configurable audible and visual annunciators (three LEDs next to display) show when weight is under, over, or at target weight.

Totalising Functionality – Allows the number of weighings and the total amount of weight to be stored and recalled.

Approvals – Approved as per Legal Metrology Act and Petroleum Rules.



LPG Cylinder Weighing

SPECIFICATIONS

Tares

Semi-automatic 100% subtractive tare.

Displays

52mm high, six digit, seven segment, LCD display.

The backlit LCD display carries icons for gross, net, tare, zero, kg.

LCD annunciators are available for Stable; Zero; Gross; Net; Tare; Hold; Low Battery.

LED annunciators are available for Over; Under; Accept on Check Weighing and Low Battery.

Controls

Controls are located on the display housing. Auto power-off function to help prolong battery life.

Main Control Functions

Gross/Net; Print; Memory Recall.

Accumulate; Tare; Zero;

Power On/Off.

Additional Control Functionality

Check Weighing; Memory Clear.

Loadcell

OIML approved, C3 accuracy. PESO Approved.

Protection

Indicator: IP65 / Flame-proof

Loadcell: IP65 for single cell scales

Environment

Operating Temperature Range:

-10° C to +45° C

Operating Humidity:

0 to 85% RH (non-condensing)

Electrical Supply

230C AC,50Hz through fixed 3 core cable, diameter 8 mm suitable for use in hazardous areas. Entry through ¾" cable gland. Cable provided by user.

Internal Rechargeable Battery:

6 V DC rechargeable battery.

12 hours to fully charge the scale.

Approximately 20 hours of continuous battery life for a single load cell and 12 hours for four cells.

Approvals

Approved as per Accuracy Class III of Legal Metrology Act.

Design approval by PESO for use in hazardous areas

DIMENSIONS

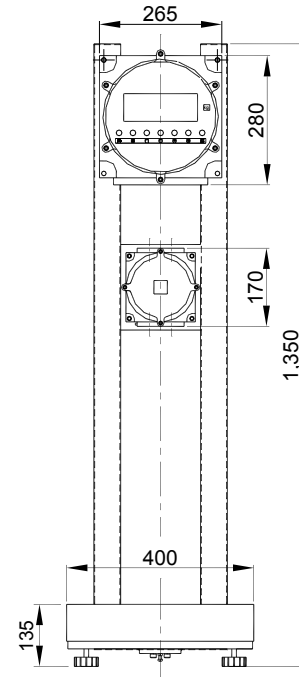

SIZES AND CAPACITIES

Size	Capacity	Display	Construction	Options
400 x 400mm	51kg x 10g	Wall / Stand Mounted	Mild steel fabricated structure with adjustable feet and spirit level.	<ul style="list-style-type: none"> Detachable FLP mains switch socket and plug to isolate mains supply Mounting stand Stainless Steel platform cover

*Other capacities and sizes available on request.

Avery Weigh-Tronix

www.averyweigh-tronix.com

Avery Weigh-Tronix is an ITW company



Avery India Ltd. is part of Avery Weigh-Tronix. Avery Weigh-Tronix is a trademark of the Illinois Tool Works group of companies whose ultimate parent company is Illinois Tool Works Inc ("Illinois Tool Works"). Copyright © 2015 Illinois Tool Works. All rights reserved. This publication is issued to provide outline information only and may not be regarded as a representation relating to the products or services concerned. This publication was correct at the time of going to print, however Avery Weigh-Tronix reserves the right to alter without notice the specification, design, price or conditions of supply of any product or service at any time.

FL_AWB_spec_in.indd
V1_0815